

**WHERE YOUR MEETINGS
GET THE STAR TREATMENT.**

Marriott.
BURBANK AIRPORT
HOTEL & CONVENTION CENTER

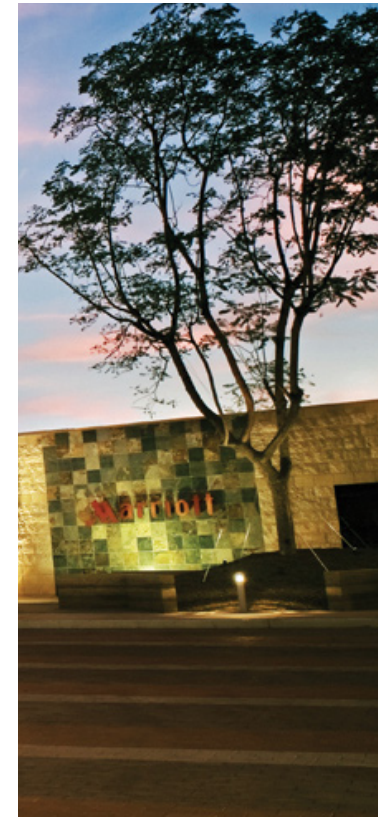

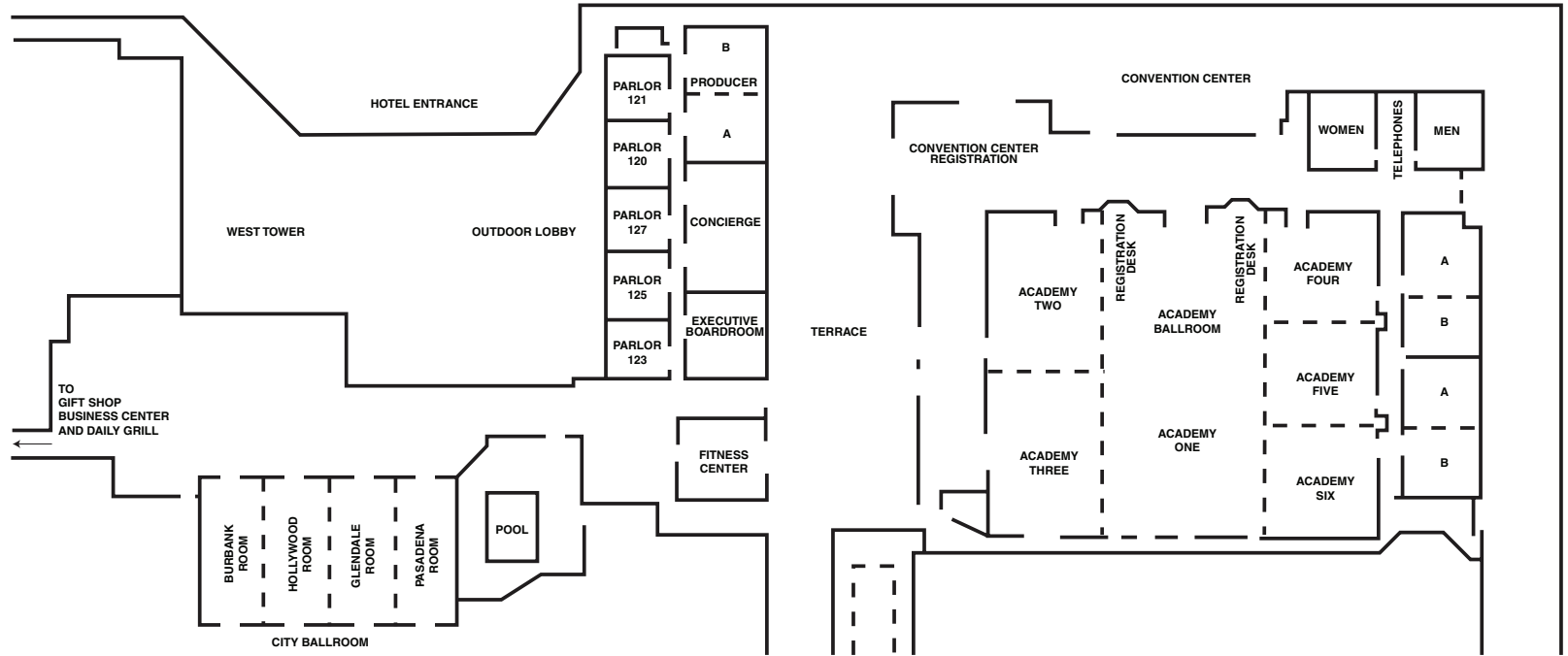

SPACE AS AMBITIOUS AS THEIR ITINERARY.

We are the future of meetings with the best-in-class meetings facilities in the Valley. 46,000 square feet of meeting space and exhibition rooms, pre-function areas and outdoor space. The Academy Ballroom which is over 15,000 square feet, is divisible into 6 sections, and can accommodate up to 2,240 for receptions and 1,300 for banquets. Twenty two meeting rooms for breakout and training sessions, as well as four beautifully appointed boardrooms. All meeting space is conveniently located on one level with direct access to the hotel.

Meeting Room	Dimensions		Capacity					
	WxLxH	Sq. Ft.	Theater	Schoolroom	Conference	U-Shape	Reception	Banquet
Academy Ballroom	143x105x18	15,015	1,900	800	–	–	2,240	1,300
One	60x105x18	6,300	800	320	–	–	940	550
Two & Three (ea)	43x53x18	2,257	250	130	–	60	340	160
Three	43x53x18	2,257	250	130	–	60	340	160
Four, Five & Six (ea)	40x35x18	1,400	130	60	40	40	250	90
Foyer	17' Ceiling	7,444	–	–	–	–	1,200	–
Vine A & B	48x24x10	1,152	100	45	40	40	100	80
Vine A or B	24x24x10	576	49	20	20	20	49	40
Sunset A & B	48x24x10	1,152	100	45	40	40	100	80
Sunset A or B	24x24x10	576	49	20	20	20	49	40
East Tower								
Producer A & B	46x18x9.5	828	40	40	40	40	80	60
Producer A or B	23x18x9.5	414	20	20	20	20	40	30
East Parlors - 5 Total	23x15x9.5	345	20	10	12	10	24	30
Parlor 123, 125, 127			–	–	14	–	–	–
Parlor 129, 131			–	10	14	10	24	30
Executive Board Room	15x24x9.5	540	–	–	14	–	–	–
City Ballroom	96x51x12	4,704	600	300	–	–	750	400
Burbank	24x51x12	1,244	100	75	40	40	196	100
Hollywood	24x51x12	1,244	100	75	40	40	196	100
Glendale	24x51x12	1,244	100	75	40	40	196	100
Pasadena	24x51x12	1,244	100	75	40	40	196	100
Foyer	10' Ceiling	3,655	–	–	–	–	315	–
North Terrace*	–	2,800	–	–	–	–	300	100
Terrace*	50x150	7,500	–	–	–	–	450	150



**BURBANK AIRPORT MARRIOTT
HOTEL & CONVENTION CENTER**

2500 Hollywood Way
Burbank, California 91505
Phone 818.843.6000
Fax 818.842.9720
Sales Fax 818.563.9182
Marriott.com/BURAP



ACCOMMODATIONS

409 spacious guest rooms and 79 suites all transformed into a sophisticated. Functional style with advanced technology. All guest rooms feature Marriott Revive bedding, 32" flat screen LCD TV with high definition capabilities with the "Plug and Play" panel and one touch "At Your Service." Also featured, High speed internet access, individual climate control, 2-line phone with voicemail, Cable TV with pay-per-view movies, AM/FM alarm clock radio, in-room coffee, hair dryer, iron and ironing board. Concierge level upgrades amenities available. ADA-accessible rooms also available. This hotel has a smoke-free policy.

RESTAURANTS & LOUNGES

Daily Grill Restaurant & Bar features American cruise and is open for breakfast, lunch and dinner daily. Lobby Day Bar serves fresh brewed Starbucks coffee daily. Lobby Night Bar features a favorite selection of wines and martinis every evening.

RECREATION & LEISURE

The hotel features 2 heated outdoor pools. Main pool area has private cabanas and fire pits, adjacent to the state-of-the-art fitness center. Our second pool features a whirlpool, fire pit and restaurant seating. Championship golf and horseback riding nearby.

ATTRACTIONS

The Burbank Airport Marriott is pivotal to many of the world's most famous visitor attractions, and is home to more than 100 soundstages and 500 production related companies producing everything from "Jurassic Park to the Ellen Degeneres Show." For the "Star Gazers" we have the Universal Studios Theme Park and City Walk, NBC Studios featuring the Jay Leno Show, Warner Bros. Studios, Disney Studios, Hollywood Walk of Fame, downtown Los Angeles, and many familiar movies sets throughout the Burbank area. We offer easy access to an array of attractions such as the magnificent Getty Center, Griffin Park, Hollywood Bowl, Los Angeles Zoo, the Rose Bowl, Dodger Stadium and the Ronald Reagan Presidential Library. Ride the tallest, fastest roller coaster in the world at Six Flags Magic Mountain.

GUEST SERVICES

Complimentary airport transportation, business center, complimentary wireless Internet throughout hotel lobby area, parking (fee), Concierge lounge, guest laundry, gift shop, safe-deposit boxes, soda, ice and vending machines.

MEETING FACILITIES

A total of 22 meeting rooms with 46,000 square feet of flexible function space, the largest in the area, 15,000 sq. ft. Academy Ballroom, divisible into 6 sections, accommodating, 2,240 for

receptions and 1,300 for banquets. City Ballroom is 5,000 square feet, Producer 1,242 square feet, East Parlors 345 square feet. All meeting space is located on one level for easy accessibility. Award winning Banquet and Catering staff, wireless Internet access throughout the hotel meeting rooms, video-conferencing and teleconferencing, In-house audiovisual capabilities. Multilingual staff. Four beautifully appointed VIP Boardrooms with modern boardroom table, luxurious leather wrapped ergonomic chairs, flat screen TV and an extensive list of audio/visual equipment.

LOCATION

Located directly across from the Burbank Airport, the hotel is 15.5 miles West of Pasadena and 15 miles north of downtown Los Angeles. Visitors can arrive via Interstate 5 or Highway 134. Burbank "Bob Hope" Airport (adjacent to the hotel) features 70 flights daily, (including direct flights to New York) and home to major carriers Alaska Air, American, Delta, Jet Blue, Skybus, Southwest, United, and US Airways. We offer complimentary all-day shuttle service to and from Burbank Airport. Los Angeles International Airport (28.3 miles.)